

A stylized landscape illustration featuring a winding river in shades of light blue and white, set against a dark green background. The river flows from the left towards the right, with a small loop in the middle. The top of the image shows dark green, jagged shapes representing hills or mountains.

**Celebrate & Conserve**



**FRIENDS OF THE  
PETALUMA RIVER**

# Steamer Landing Park



- *An open space park in the heart of downtown Petaluma*
- *A place for River connection*
- *A hub for programming*
- *A place for gathering and celebration*



# Promoting Access

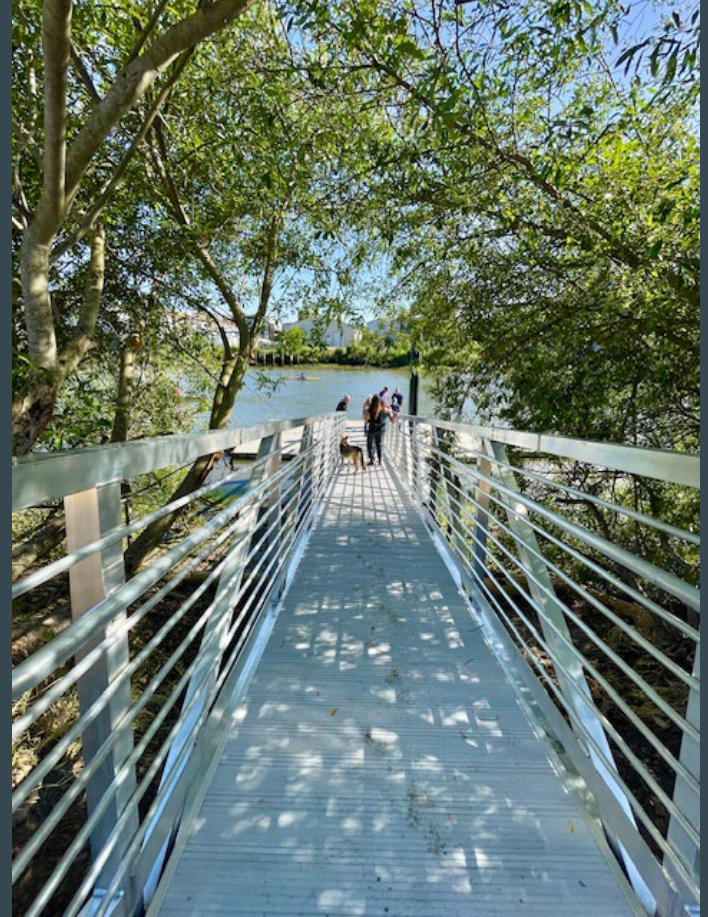



# Petaluma River Greenway

Permanently Protecting 176 acres  
along the upper Petaluma River for  
restoration, open space and public  
recreation.









# PROJECT GOALS

Improve Quality of Life for Residents

Provide Public Access and Education

Climate Change Resilience for People & Nature

Climate Change Mitigation

Protection from Stormwater Flooding

Water Quality Protection



# PETALUMA RIVER GREENWAY CONCEPT MAP

## The River's Legacy

The upper reach of the Petaluma River from Lynch Creek Trail to Corona Road is one of the last remaining unprotected open space within the City of Petaluma. This open space is connected to several public recreation facilities and commercial centers, is important to the City's resilience to climate change, and is an area of outstanding beauty and biological richness. A greenway here would make Petaluma even more of a destination city for outdoor activities accessible to all, and leave a legacy for generations to enjoy.

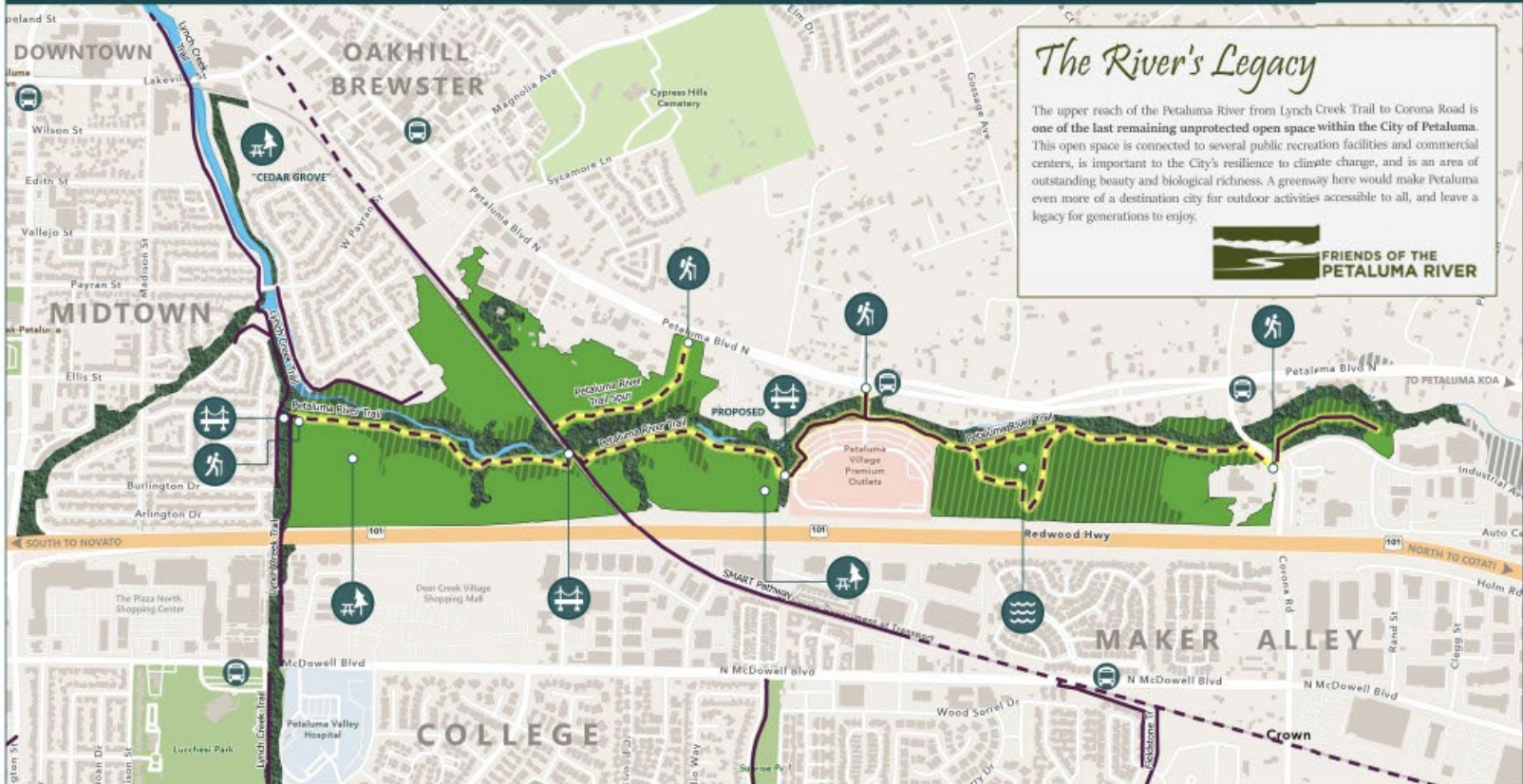

- Trailhead - Petaluma River Trail
- Potential Park Site
- Accessible Multi-Use Bridge
- Existing Wetland Mitigation Site
- Existing Petaluma River Trail
- Potential Petaluma River Trail
- Existing Multi-Use Path
- Planned Multi-Use Path
- Annual Grassland
- Riparian Woodland & Oak Savannah Restoration Potential
- Existing Riparian Woodland

0 0.1 0.2 Miles

0 250 500 750 1000 Feet

**MAP PERSPECTIVE**

Map produced by Tom Robinson Consulting for Friends of the Petaluma River using ArcGIS software, April 2020



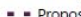

# Petaluma River Parkway Parcel Map

## Multi-use Trails



-  Existing
-  Proposed

## Parcels in the Project Area

### Acquisition Strategy

-  Essential Acquisition (11 parcels, 136 acres)
-  Essential Use Agreement or Lot Split (3 parcels)
-  Important, Not Essential (3 parcels, 21 acres)

### Other Parcels

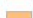
-  Sonoma Water (5 parcels, 8 acres)
-  Developed (18 parcels, 33 acres)
-  Planned Development (1 parcel, 4 acres)

 City Limits

Parcels are labeled with index numbers that correspond to records in the accompanying spreadsheet.

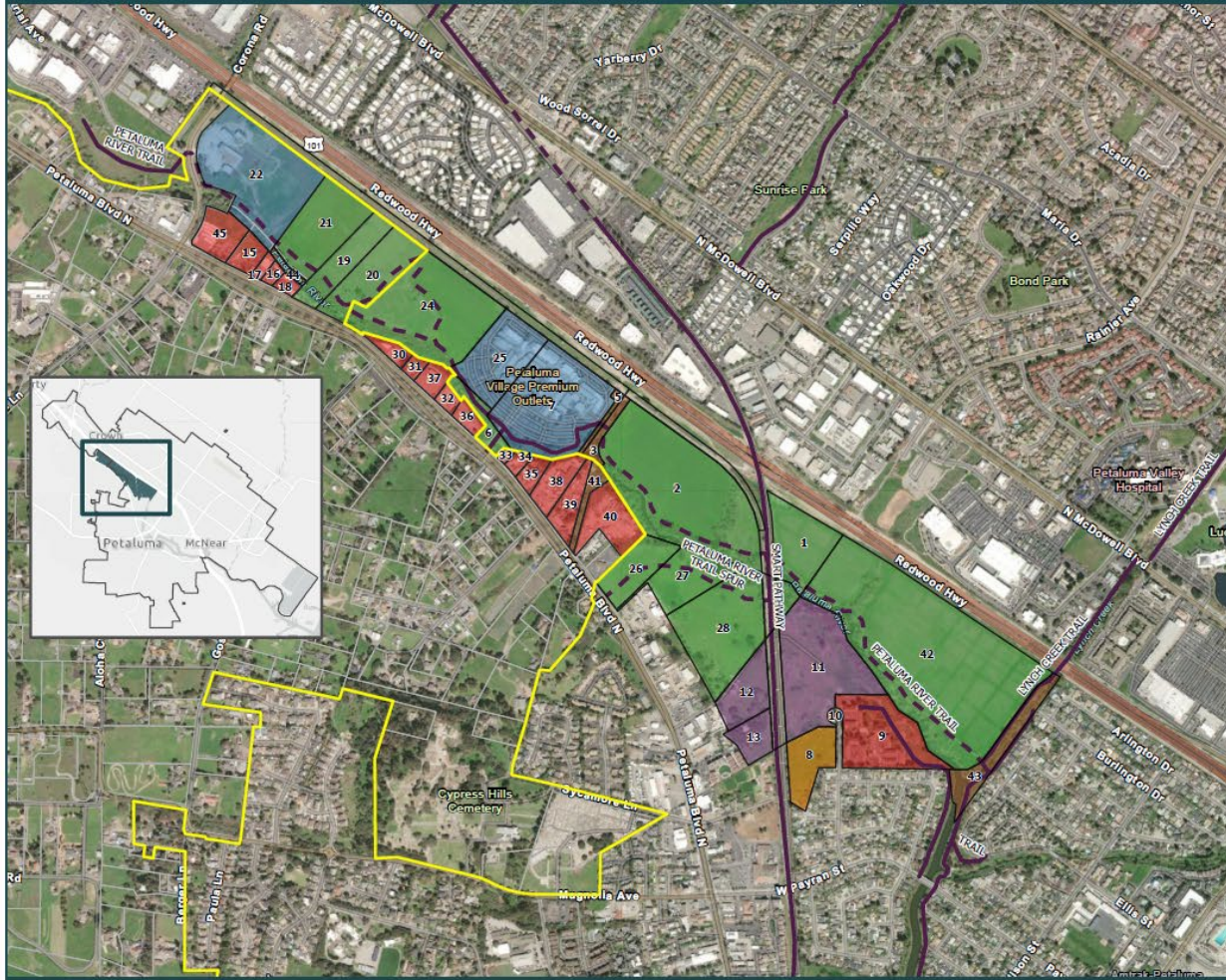
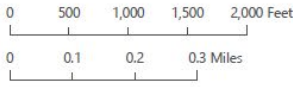



# Phase 1 Deliverables

## 1. Baseline Information

- Existing Conditions Report
- Opportunities & Constraints Map

## 2. Community Engagement

- Community Engagement Strategy
- Project Graphics & Messaging
- Presentation Materials
- Public & Stakeholder Meetings

## 3. Draft Concept Designs

# Acquisition Update

- Although 45 parcels in the project area...
- 7 owners → 17 priority parcels
- 5 owners → 13 “essential” parcels
- 1<sup>st</sup> Priority – Johnson Parcels

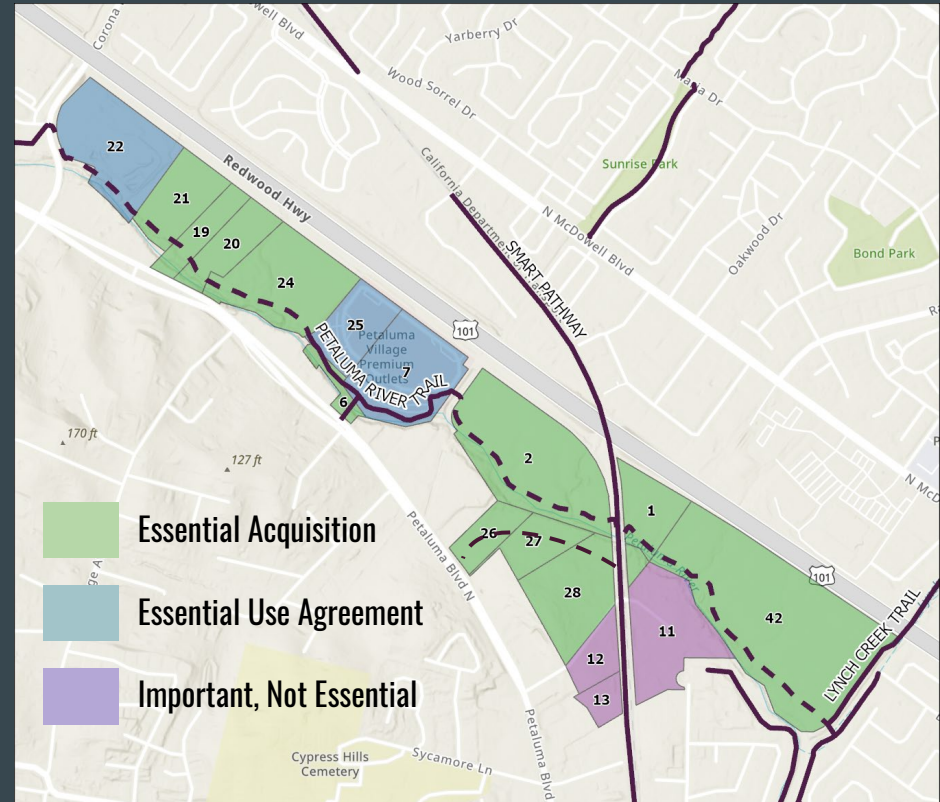



# Partners

## City of Petaluma

"How do we ensure the River acts as the lifeblood of the community?" Peggy Flynn, City Manager

"Everything we're talking about today is in line with what we've been hearing, what we're driving toward."  
--Heather Hines, Lead City Planning

## Sonoma Water

Zone 2A Flood Protection - \$40k for parcel study

## Sonoma Land Trust

Providing guidance and planning support  
Possible lead project partner

## Local Leaders

Mayor Kevin McDonnell

Councilmembers

Supervisor Rabbitt

Senator McGuire

Congressman Huffman

## Community Organizations & Agencies

Cool Cities Petaluma

Petaluma River Park

Sonoma Resource Conservation District

Sonoma County Open Space & Agricultural

Preservation District

# Top Funding Opportunities

## State Agencies & Local Sources

- Coastal Conservancy grant 460k
- Wildlife Conservation Board
- Urban Flood Protection
- Urban Greening
- Environmental Enhancement & Mitigation
- 2024 1Billion Climate Bond
  - Climate resilience
  - Equitable Access
  - Habitat

